

FOR SALE:

1340 MARSHALL FARMS RD. OCOOE, FL 34761



8 ACRES IN OCOEE

SUMMARY:

- ◆ Excellent location at 429 and Turnpike
- ◆ ± 8.14 acres
- ◆ C-3 General Commercial Zoning - City of Ocoee
- ◆ Site plan and permit previously approved
- ◆ Superb access to major highways

SALE PRICE: \$1,100,000

CITY COMMERCIAL

For further information, contact

Lee Zerivitz, CCIM

Office: 407.644.CITY (2489)

Cell: 407.929.3598

Email: lee@citycommercial.com

Web: www.CityCommercial.com

213 West Comstock Avenue ♦ Winter Park, FL 32789

CITY Commercial is the agent of the Landlord or Seller of this property and will be paid by the Landlord or Seller. All information furnished with respect to the subject property has been obtained from sources deemed reliable. No representation as to accuracy thereof is made. This offering is subject to errors, omissions, prior sales or withdrawal without notice.

FOR SALE:

1340 MARSHALL FARMS RD. OCOOEE, FL 34761

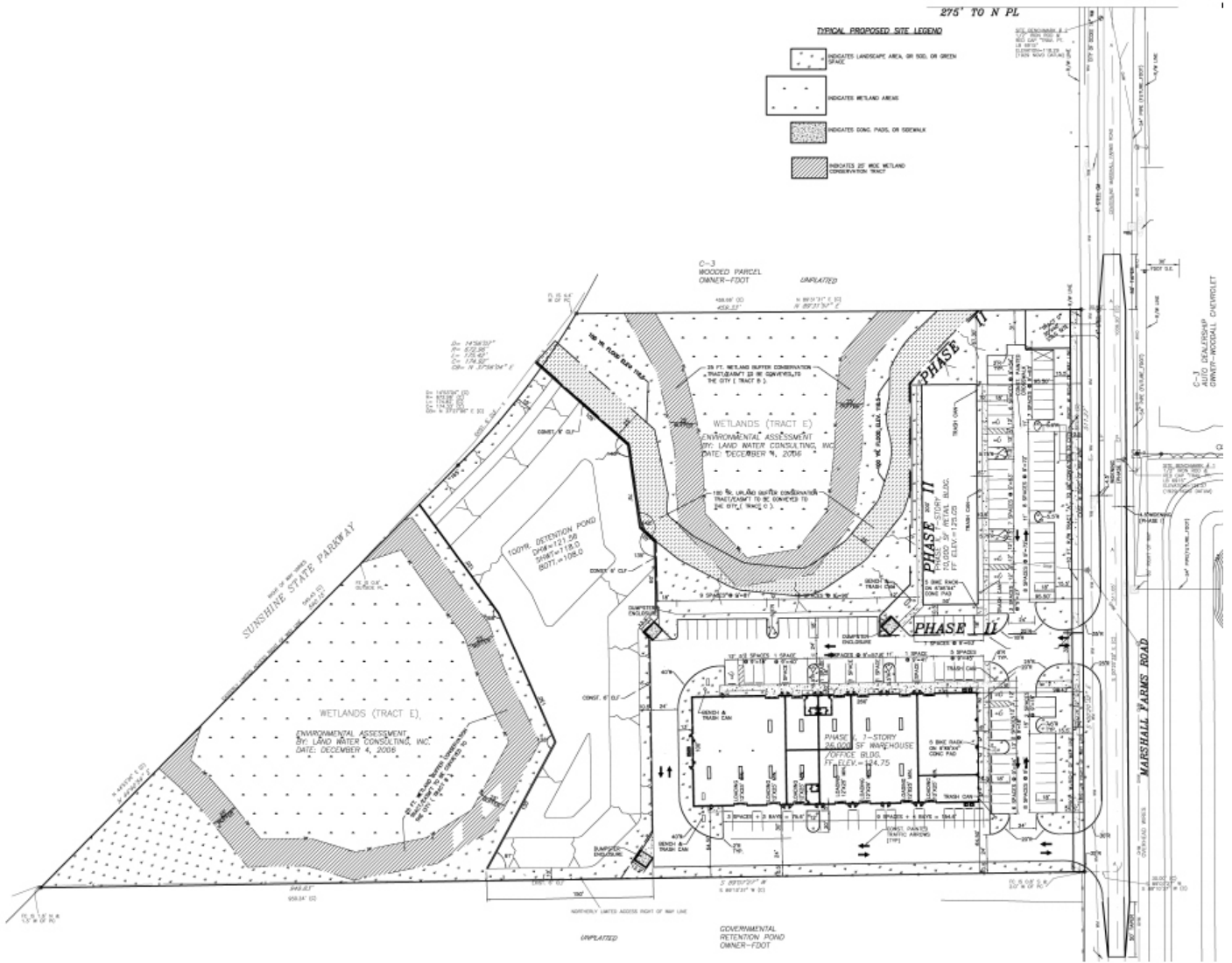

CITY COMMERCIAL

For further information, contact

Lee Zerivitz, CCIM

Office: 407.644.CITY (2489)

Cell: 407.929.3598

Email: lee@citycommercial.com

Web: www.CityCommercial.com

213 West Comstock Avenue ♦ Winter Park, FL 32789

CITY Commercial is the agent of the Landlord or Seller of this property and will be paid by the Landlord or Seller. All information furnished with respect to the subject property has been obtained from sources deemed reliable. No representation as to accuracy thereof is made. This offering is subject to errors, omissions, prior sales or withdrawal without notice.